



8300 Highland Drive
Wausau, WI 54401

CHRIS GHIDORZI
m: 715.302.8185
chrisg@ghidorzi.com

2100 Stewart Ave., Suite 300
Wausau, WI 54401
www.ghidorzi.com



Features

- 101,400 sq ft. with 24' clear span
- 40,000 – 101,400 sq ft. with 52' base spacing
- Tilt-up concrete construction
- Easy access from WI-29
- Developed office area
- 10 loading docks

Available Space

40,000 – 101,400 sq ft.

Anchor Tenant

Fiskars Distribution Center

Area Map

image by Google® maps

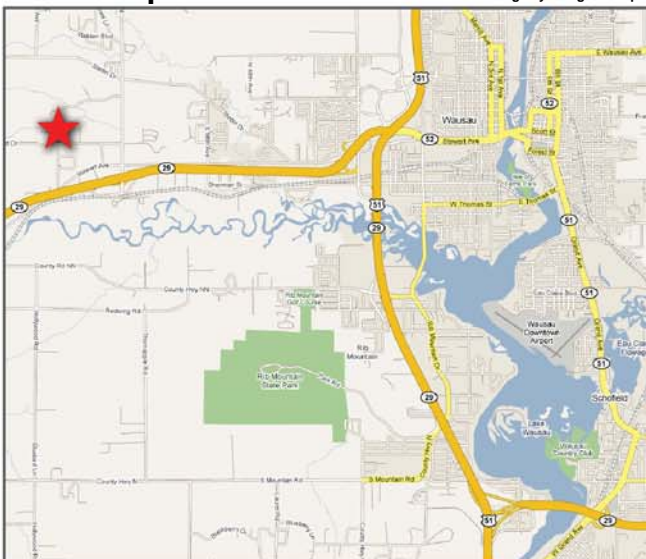

THIS DOCUMENT HAS BEEN PREPARED SOLELY FOR INFORMATION PURPOSES. WHILE THE INFORMATION CONTAINED HEREIN IS FROM SOURCES DEEMED RELIABLE, IT HAS NOT BEEN INDEPENDENTLY VERIFIED. THIS DOCUMENT IS PROVIDED SUBJECT TO ERRORS, OMISSIONS AND CHANGES IN INFORMATION.



8300 Highland Drive

Site Plan

CHRIS GHIDORZI
m: 715.302.8185
chrsg@ghidorzi.com

2100 Stewart Ave., Suite 300
Wausau, WI 54401
www.ghidorzi.com

