



CHRIS GHIDORZI
 m: 715.302.8185
 chrsg@ghidorzi.com

2100 Stewart Ave., Suite 300
 Wausau, WI 54401
 www.ghidorzi.com

Corporate Cove Tower

One Corporate Drive
 Wausau WI, 54401



Available Space

1,119 to 3,914 sq. ft. rentable

Demographics

ROAD	AVERAGE ANNUAL DAILY TRAFFIC 2004 (vehicles)
US 51/I-39	62,500

CITY	EST. 2007 POPULATION
Wausau	38,881
Wausau Metro	102,511

Anchor Tenants

Virchow Krause, Aqua Finance, Security Health

Area Map

image by mapquest.com

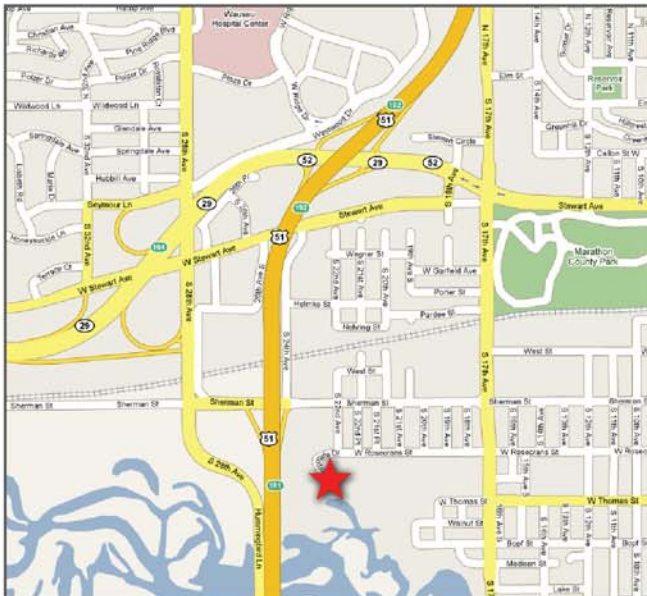

Features

- Class A office space
- High visibility and easy access from US 51/I-39
- Building is a prominent part of the Wausau skyline
- Spectacular views of Lake Wausau, Rib Mountain and surrounding area

THIS DOCUMENT HAS BEEN PREPARED SOLELY FOR INFORMATION PURPOSES. WHILE THE INFORMATION CONTAINED HEREIN IS FROM SOURCES DEEMED RELIABLE, IT HAS NOT BEEN INDEPENDENTLY VERIFIED. THIS DOCUMENT IS PROVIDED SUBJECT TO ERRORS, OMISSIONS AND CHANGES IN INFORMATION.



Corporate Cove Tower Site Plan

CHRIS GHIDORZI
m: 715.302.8185
chrisg@ghidorzi.com

2100 Stewart Ave., Suite 300
Wausau, WI 54401
www.ghidorzi.com

